

Call Michael Oswald Today!!
Mobile: 662-719-3967
michael@tomsmithland.com

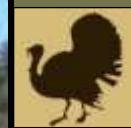

Office: 601-898-2772
Fax: 601-898-8278
www.TomSmithLandandHomes.com

20.69 ± ACRE RURAL RESIDENTIAL/PASTURELAND PROPERTY IN LINCOLN COUNTY, MS



\$2,500/Acre

- Secluded Property
- Previous Home Site
- All Utilities Available but Sewer
- Long Driveway from Road
- Abundant Deer and Turkey
- Very Open for Food Plots
- Backs up to Natchez Trace
- Gently Rolling

Looking for land to build your dream home, weekend retreat, or deer camp in rural Lincoln County? Look no further! You will be sitting on your porch watching deer and turkey walk through your yard in no time. This property features 20.69 ± acres along the west side of Jackson-Liberty Road. The property includes mainly beautiful open rolling pasture with a small portion of hardwoods along the western end. There are multiple home sites throughout the open pastureland area. A small creek **borders the property on the western end. All utilities are in place except sewer. Don't let this property pass you by!** DIRECTIONS: From the intersection of Highway 28 and Sylvarena Road, take Sylvarena Road South approximately 1.80 miles, take Jackson-Liberty Road South approximately 3.40 miles, the property will be on the right. This property won't last long!!! Call Michael Oswald today!!



Michael Oswald, Realtor®
Mobile 662-719-3967
Michael@TomSmithLand.com
Tom Smith Land and Homes LLC





Michael Oswalt, Realtor®
Mobile 662-719-3967
Michael@TomSmithLand.com
Tom Smith Land and Homes LLC
601 Crescent Blvd, Suite 103
Ridgeland, MS 39157



Ownership Map



Michael Oswalt, Realtor®
 Mobile 662-719-3967
 Michael@TomSmithLand.com
 Tom Smith Land and Homes LLC
 601 Crescent Blvd, Suite 103
 Ridgeland, MS 39157



Aerial Map



Michael Oswalt, Realtor®
Mobile 662-719-3967
Michael@TomSmithLand.com
Tom Smith Land and Homes LLC
601 Crescent Blvd, Suite 103
Ridgeland, MS 39157

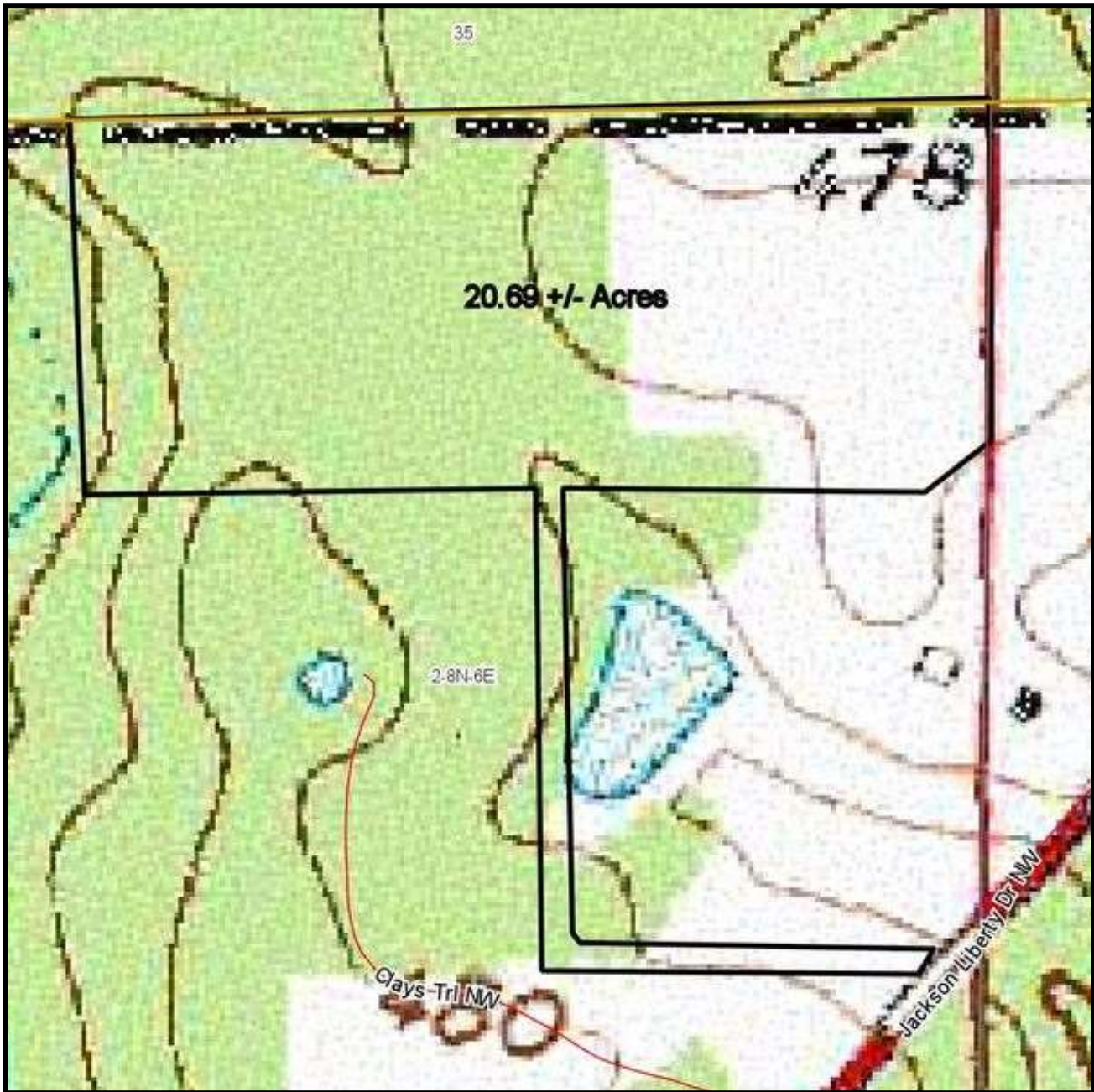

Topographical Map



Michael Oswalt, Realtor®
Mobile 662-719-3967
Michael@TomSmithLand.com
Tom Smith Land and Homes LLC
601 Crescent Blvd, Suite 103
Ridgeland, MS 39157

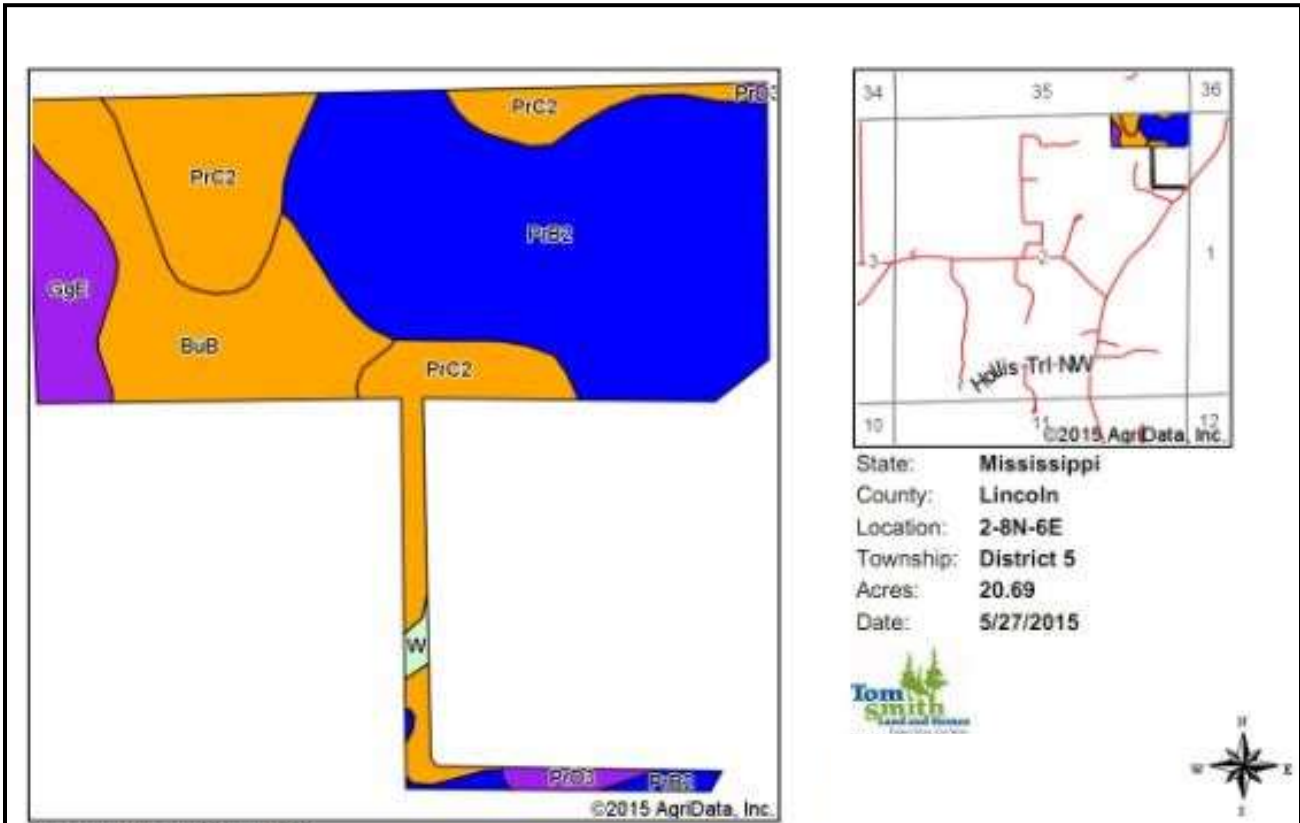

Area Symbol: MS085, Soil Area Version: 11

Code	Soil Description	Acres	Percent of field	Non-Irr Class Legend	Non-Irr Class %	Bahiagrass	Common bermudagrass	Corn	Cotton lint	Improved bermudagrass	Soybeans	Tall fescue	Wheat
PrB2	Providence silt loam, 2 to 5 percent slopes, eroded	10.28	49.7%		Iie	8.5		90	750	9.5	40	8.5	40
PrC2	Providence silt loam, 5 to 8 percent slopes, eroded	4.77	23.1%		Ilie	8.2		80	575	8.8	30	8	37.5
BuB	Bude silt loam, 2 to 5 percent slopes	3.87	18.7%		Ilie			80	600	9.5	25	8	35
GgE	Gun gravelly sandy loam, 12 to 17 percent slopes (aaffel)	1.40	6.8%		Vie	5	3.5			4.5			
PrD3	Providence silt loam, 8 to 12 percent slopes, severely eroded	0.26	1.3%		Vie	8		40	675	9	35	7.5	35
W	Water	0.10	0.5%										
Weighted Average						6.6	0.2	79.2	626.3	8.9	31.9	7.7	35.5

Soil Map



Michael Oswalt, Realtor®
 Mobile 662-719-3967
 Michael@TomSmithLand.com
 Tom Smith Land and Homes LLC
 601 Crescent Blvd, Suite 103
 Ridgeland, MS 39157



Directional Map

DIRECTIONS: DIRECTIONS: From the intersection of Highway 28 and Sylvarena Road, take Sylvarena Road south approximately 1.80 miles, take Jackson-Liberty Road south approximately 3.40 miles, the property will be on the right.



Michael Oswalt, Realtor
Mobile 662-719-3967
Michael@TomSmithLand.com
Tom Smith Land and Homes LLC
601 Crescent Blvd, Suite 103
Ridgeland, MS 39157